

A

B

NOTES: (UNLESS OTHERWISE SPECIFIED)

1. ASSEMBLY WEIGHT: .05 LBS MAX
2. PROTECT COSMETIC SURFACES FROM DAMAGE

| REVISIONS | | | | | | |
|-----------|-----|---|----------|-----|---------|------|
| ZONE | REV | DESCRIPTION | DATE | BY | EC NO. | APRV |
| | A | INITIAL RELEASE | 02/06/18 | MCS | 18-0080 | |
| NOTES | B | REMOVE QCP NOTE, CHANGE PROJECT FROM "SMARTFLEX" TO "MIP" | | | | |

1

1

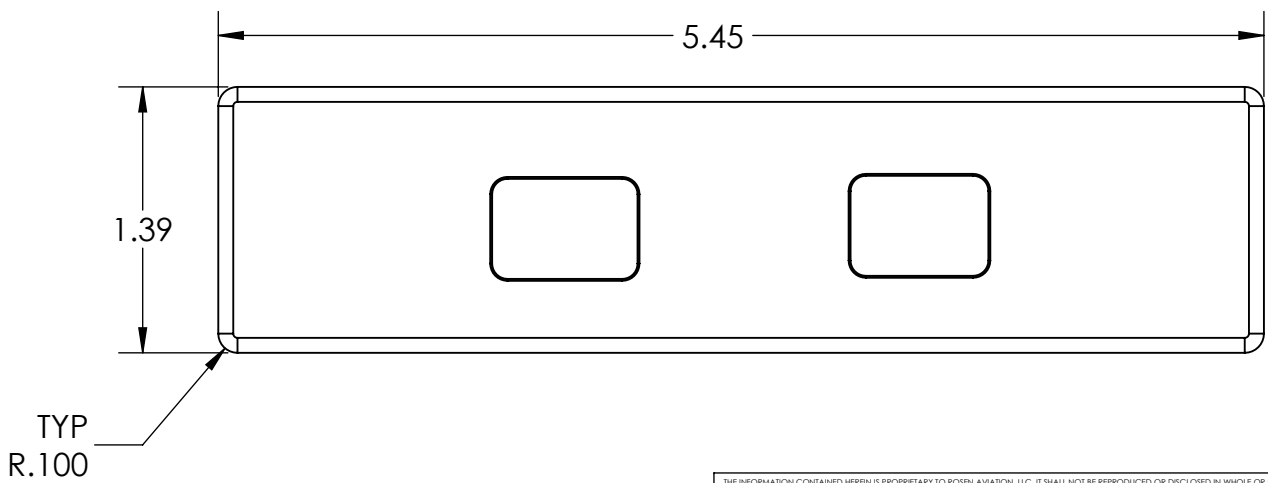
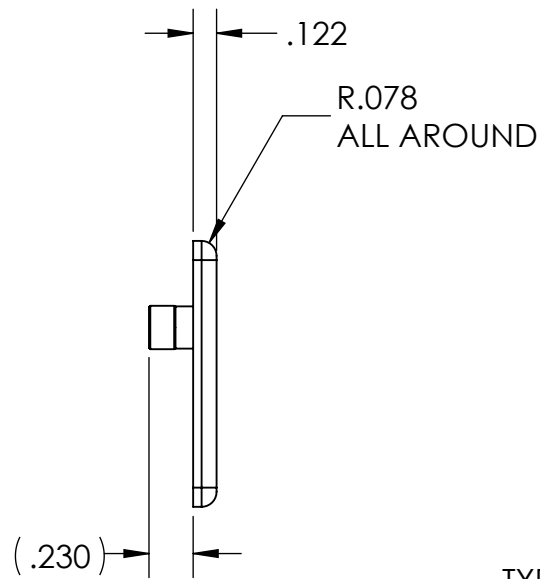
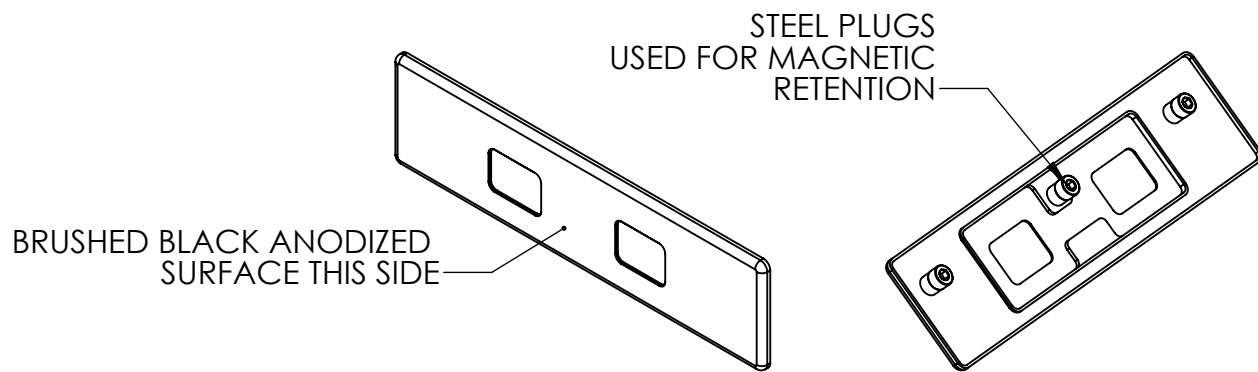

2

2

THE INFORMATION CONTAINED HEREIN IS PROPRIETARY TO ROSEN AVIATION, LLC. IT SHALL NOT BE REPRODUCED OR DISCLOSED IN WHOLE OR IN PART OR USED FOR ANY DESIGN OR MANUFACTURE EXCEPT WHEN SUCH USER POSSESSES DIRECT, WRITTEN AUTHORIZATION FROM ROSEN AVIATION, LLC. THIS DRAWING MAY BE COVERED UNDER ONE OR MORE U.S. OR INTERNATIONAL PATENTS. PLEASE CONTACT ROSEN AVIATION FOR SPECIFIC INFORMATION.

ROSEN AVIATION
 1020 OWEN LOOP SOUTH
 EUGENE, OREGON 97402
 TEL: (541) 342-3802 FAX: (541) 342-4912

| APPROVALS | INITIAL | DATE |
|-----------|---------|----------|
| DRAWN BY | MCS | 01/31/18 |
| CHECKER | BEF | 02/02/18 |
| ENGINEER | MCS | 02/02/18 |

TITLE
**OUTLINE AND INSTALLATION
 DRAWING, MIP, BEZEL, ANODIZED**

MIP100-901-CD

UNLESS OTHERWISE SPECIFIED DIMENSIONS ARE IN INCHES
 .X = ±.1
 .XX = ±.02
 .XXX = ±.005
 ∠ = ± 1.0°
 RADII ± .020
 INTERPRET DIM AND TOL PER ASME Y14.5M - 1994

FIRST CALLED FOR: (PCF)
359-MIP

| SIZE | REV |
|-------------------------|----------|
| A | B |
| SCALE: 1:1 SHEET 1 OF 1 | |

A

B © 2018 ROSEN AVIATION, LLC