

NOTES: (UNLESS OTHERWISE SPECIFIED)

1. ASSEMBLY WEIGHT 0.80 LBS MAX
2. OBSERVE ESD SAFE HANDLING PRACTICES
3. SOME MINOR PARTS, LABELS, AND INSTRUCTIONS OMITTED FOR CLARITY
4. VENTING: NATURAL CONVECTION, ALLOW FOR .50 INCHES AROUND THE LRU EXCEPT FOR MOUNTING SURFACES
5. SEE SHEET 2 FOR PIN-OUT INFORMATION, REFERENCE SPECIFICATIONS, AND SUGGESTED CUT-OUT DIMENSIONS
6. MINIMUM PANEL INSTALLATION THICKNESS: .375 INCHES
7. UNIT MAY BE MOUNTED FLAT, HORIZONTAL WITH THE SCREEN FACING UP OR WALL MOUNTED, VERTICAL. DO NOT INSTALL INTO CEILING HORIZONTAL, WITH SCREEN FACING DOWN.
8. MATING CONNECTOR NOT INCLUDED
9. LABEL LOCATION, APPROXIMATELY AS SHOWN
10. SEE TECHNICAL MANUAL FOR ADDITIONAL INSTALLATION AND FUNCTIONAL DETAILS
11. TOUCH TECHNOLOGY: CAPACITIVE TOUCH
12. PART CONTAINS FCC ID T7V1316
13. SEE QUALITY CONTROL PLAN, IF APPLICABLE, FOR ANY CRITICAL ITEMS, SPECIAL PROCESSES, OR KEY CHARACTERISTICS THAT MAY EXIST
14. MATING HARNESS TO BE STRAIN RELIEVED TO AIRCRAFT WITHIN 12 INCHES OF LINE REPLACEABLE UNIT (LRU) CONNECTOR. HARNESS IS USED TO RETAIN LRU FOR CRASH SAFETY. ENSURE MATING HARNESS WITH OVERBRAID OR EXPANDO IS CAPABLE OF HOLDING 16 LBS OF TENSION OR MORE

REVISIONS						
ZONE	REV	DESCRIPTION	DATE	BY	EC NO	APRV
	A	RELEASE TO PRODUCTION	08/09/2017	BEF	17-0497	
NOTES	B	ADD NOTES 13 & 14	02/23/18	MCS	18-0130	SC

# Electronic Revision Controlled

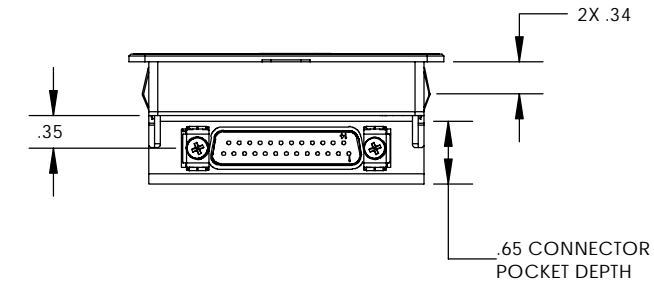
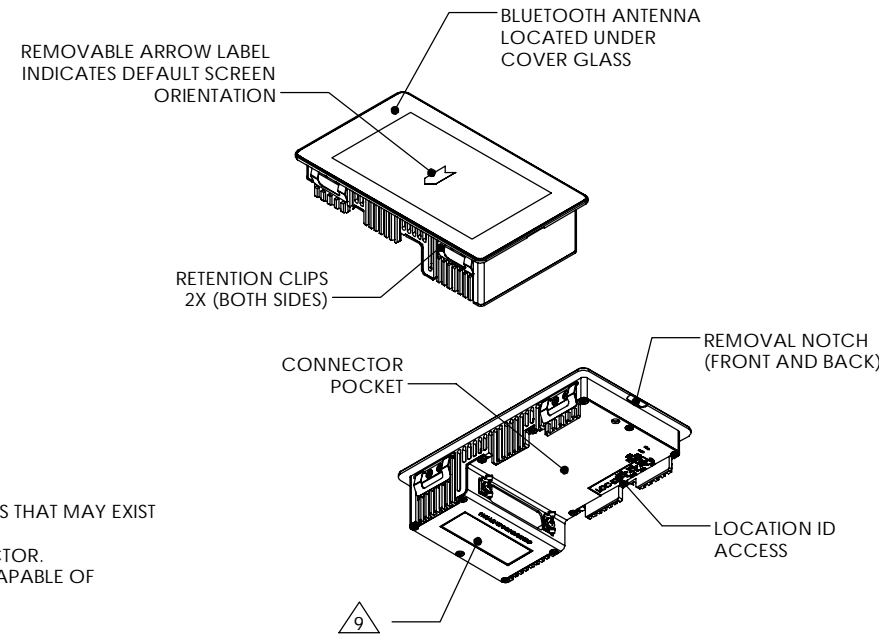

#6-32,  $\nabla$ .188  
CHASSIS GND/HARNESS STRAIN RELIEF

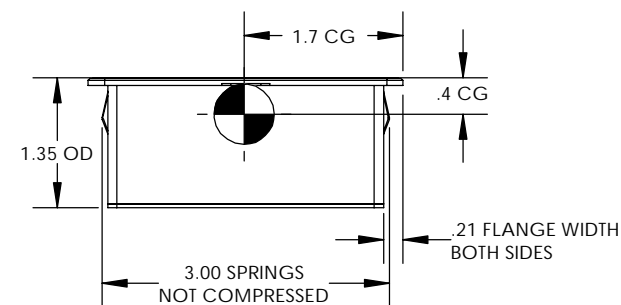
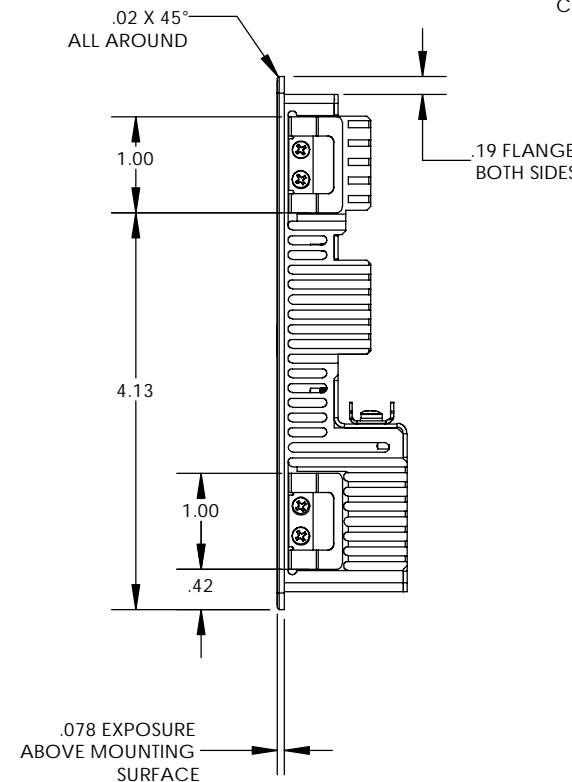
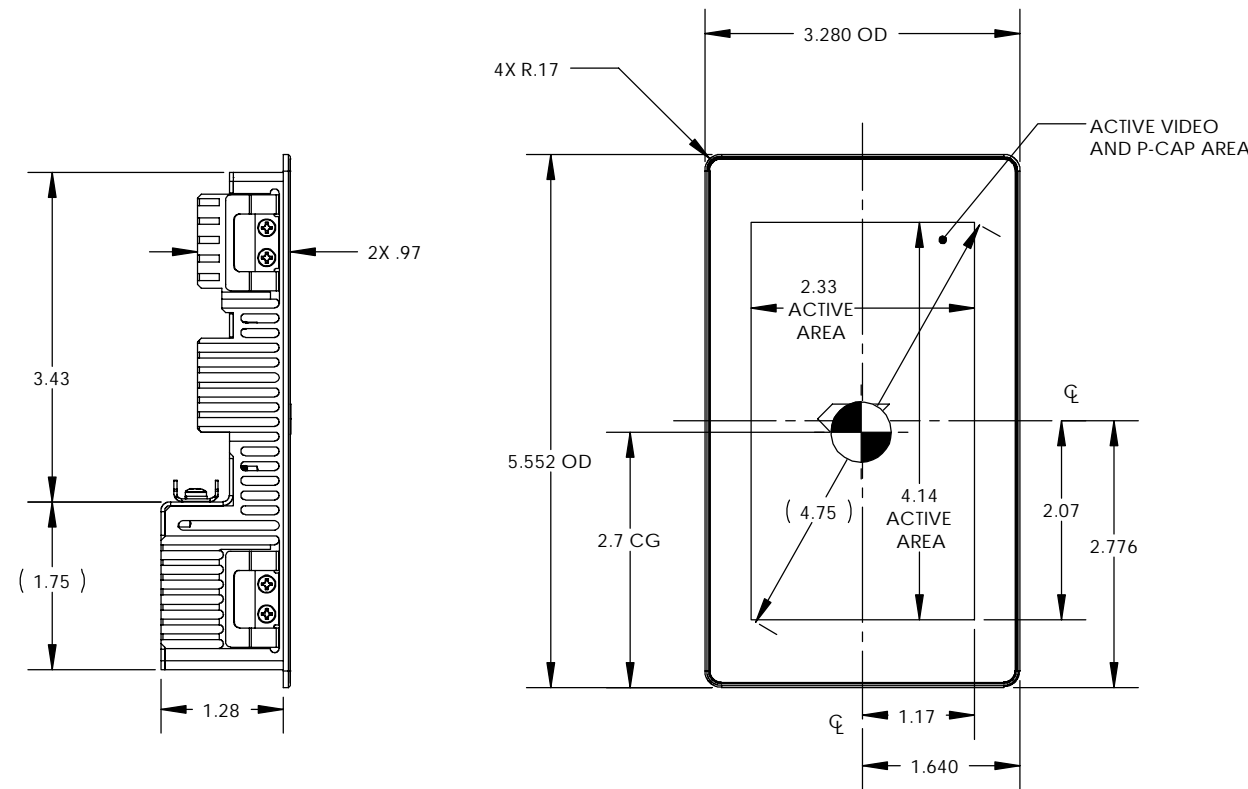
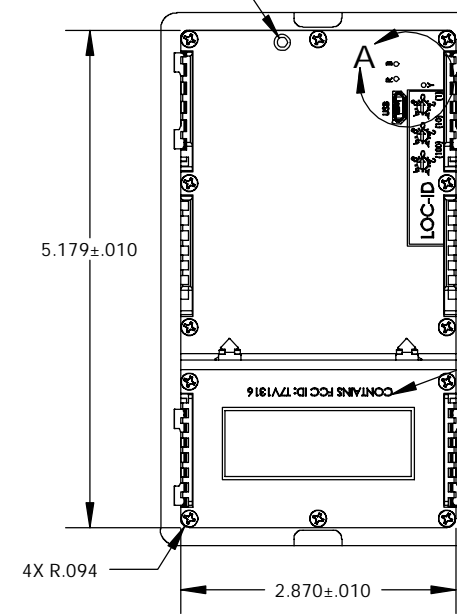

THE INFORMATION CONTAINED HEREIN IS PROPRIETARY TO ROSEN AVIATION, LLC. IT SHALL NOT BE REPRODUCED OR DISCLOSED IN WHOLE OR IN PART OR USED FOR ANY DESIGN OR MANUFACTURE EXCEPT WHEN SUCH USER POSSESSES DIRECT, WRITTEN AUTHORIZATION FROM ROSEN AVIATION, LLC. THIS DRAWING MAY BE COVERED UNDER ONE OR MORE U.S. OR INTERNATIONAL PATENTS. PLEASE CONTACT ROSEN AVIATION FOR SPECIFIC INFORMATION.

<b>ROSEN AVIATION</b> 1020 OWEN LOOP SOUTH EUGENE, OREGON 97402 TEL: (541) 342-3802 FAX: (541) 342-4912	APPROVALS	INITIAL	DATE
	DRAWN BY	BEF	08/07/17
	CHECKER	MCS	08/08/17
TITLE	ENGINEER	BEF	08/09/17
<b>OUTLINE AND INSTALLATION DRAWING,          4.7 TOUCHSCREEN CONTROL PANEL</b>			
FIRST CALLED FOR: (FCF) <b>364 - 4.7 CTS</b>			
SIZE <b>B</b>	SCALE: 1:2		REV <b>B,</b>
SHEET 1 OF 2			

UNLESS OTHERWISE SPECIFIED DIMENSIONS ARE IN INCHES  
 X = ±.1  
 XX = ±.03  
 XXX = ±.015  
 <math>\varnothing</math> = ±.020  
 RADII ±.020  
 INTERPRET DIM AND TOL PER ASME Y14.5M-1994

**PERFORMANCE SPECIFICATIONS (REF)**

LCD Performance *	
Screen Resolution (pixels)	RGB 720 (H) X 1280 (V)
Display Viewing Area (mm)	105.2 (H) X 59.2 (V)
Horizontal Viewing Angle	±80°
Vertical Viewing Angle	±80°
Contrast Ratio (Typical)	700:1
Screen Brightness (Typical)***	270 cd/m <sup>2</sup>

Power Requirements	
Operational Voltage Range	18 to 32.0 VDC
Max Current at Nominal Voltage**	0.45 Amps @ 28VDC
Inrush Peak	4.2 Amps
Inrush Duration	2 ms

Environmental Specifications	
Operating Temperature	-15°C TO 55°C
Altitude	15,000ft
Humidity	95%RH
Vibration	DO-160G Cat S (Curve B)
Power Input	DO-160G Cat Z(A)
Radio Frequency Susceptibility	DO-160G Cat T
Emission of RF Energy	DO-160G Cat M

\* LCD MANUFACTURER'S SPECIFICATION

\*\* CURRENT DRAW WILL INCREASE AS VOLTAGE DECREASES (CONSTANT POWER)

\*\*\* PANEL USES BLANVIEW TECHNOLOGY AND IS READABLE IN FULL SUNLIGHT AT THE STATED SCREEN BRIGHTNESS

\*\*\*\* ETHERNET SUPPORTS 2 LINES OF 100 BASE-T WITH SWITCHING

\*\*\*\*\* MAX RELAY CURRENT IS 1.5 AMPS

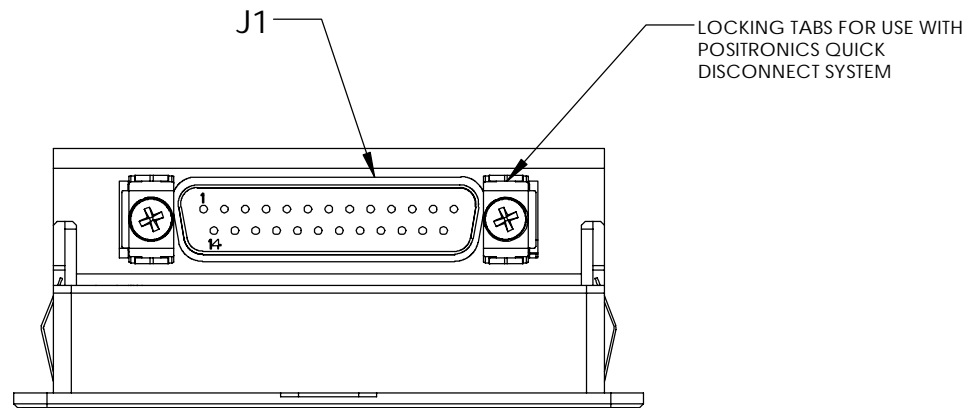

**SUGGESTED CUT-OUT DIMENSIONS**

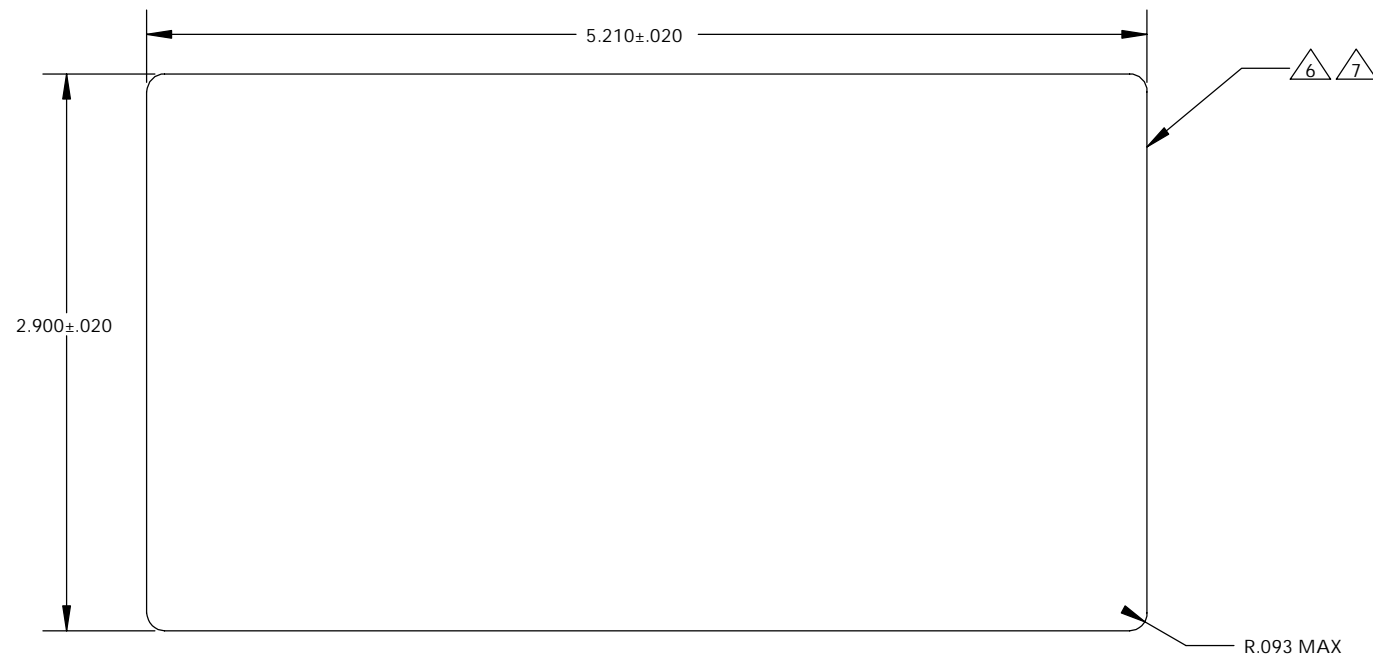

J1	
LRU CONNECTOR DB-25, MALE PINS	
SUGGESTED MATING CONNECTOR	
HOUSING	POSITRONIC: SD25F0000Z
CONTACT	POSITRONIC: FC7520D
SHELL	POSITRONIC: D25000ANVL0
PIN-OUT	
Pin #	Function
1	+28V DC
2	+28 VDC Return
3	Relay 1A *****
4	Relay 1B *****
5	Relay 2A *****
6	Relay 2B *****
7	Relay 3A *****
8	Relay 3B *****
9	Relay 4A *****
10****	Ethernet out TX2+
11****	Ethernet out TX2-
12****	Ethernet in TX1+
13****	Ethernet in TX1-
14	RS232 - Rx
15	Audio Shield
16	Audio GND
17	RS232 - Tx
18****	Ethernet out RX2+
19****	Ethernet out Rx2-
20	Comm, (Tx/Rx) GND
21	Audio Left
22	Audio Right
23****	Ethernet in RX1+
24****	Ethernet in RX1-
25	Relay 4B
B/S	Chassis GND (backshell)

THE INFORMATION CONTAINED HEREIN IS PROPRIETARY TO ROSEN AVIATION, LLC. IT SHALL NOT BE REPRODUCED OR DISCLOSED IN WHOLE OR IN PART OR USED FOR ANY DESIGN OR MANUFACTURE EXCEPT WHEN SUCH USER POSSESSES DIRECT, WRITTEN AUTHORIZATION FROM ROSEN AVIATION, LLC. THIS DRAWING MAY BE COVERED UNDER ONE OR MORE U.S. OR INTERNATIONAL PATENTS. PLEASE CONTACT ROSEN AVIATION FOR SPECIFIC INFORMATION.



1020 OWEN LOOP SOUTH  
EUGENE, OREGON 97402  
TEL: (541) 342-3802 FAX: (541) 342-4912

SIZE B	CTS047-001-CD	REV B
SCALE: 1:1	SHEET 2 OF 2	